

WEST SUSSEX COUNTY COUNCIL
((CRAWLEY BOROUGH) (PARKING PLACES AND TRAFFIC REGULATION)
(CONSOLIDATION) ORDER 2010)
(CRAWLEY: STEVENSON WAY AMENDMENT) ORDER 2012

CRAWLEY BOROUGH: LOCATION OF WAITING RESTRICTIONS

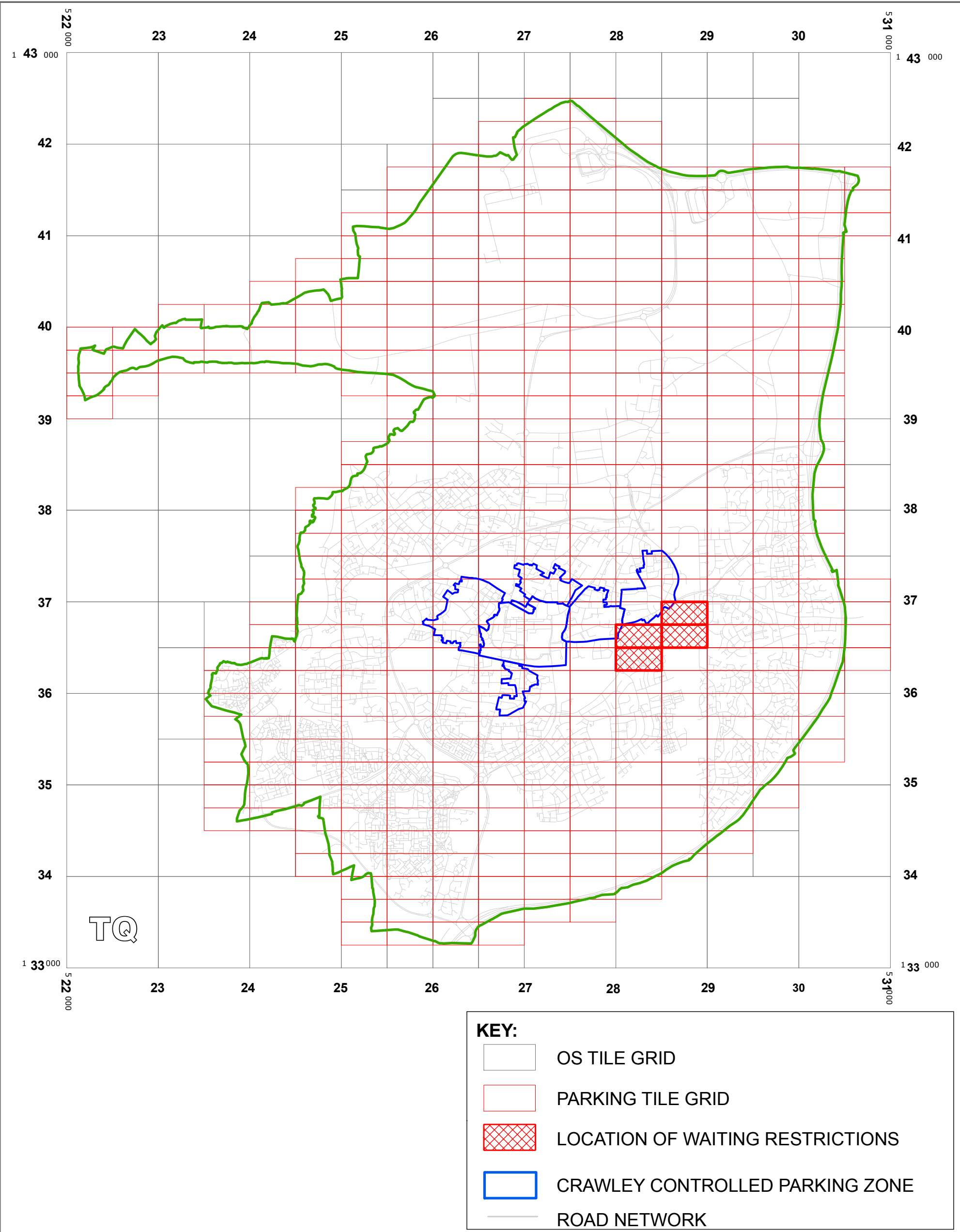

West Sussex County Council
Communities & Infrastructure
The Grange
Tower Street
Chichester
West Sussex
PO19 1RH

WEST SUSSEX COUNTY COUNCIL
(CRAWLEY BOROUGH) (PARKING PLACES AND
TRAFFIC REGULATION) (CONSOLIDATION) ORDER 2010)
(CRAWLEY: STEVENSON WAY AMENDMENT)
ORDER 2012

LOCATIONS OF WAITING RESTRICTIONS

Reproduced from or based upon 2010 Ordnance Survey mapping
with permission of the Controller of HMSO (c) Crown Copyright reserved.
Unauthorised reproduction infringes Crown copyright and may lead
to prosecution or civil proceedings West Sussex County Council Licence No. 100023447

SCALE: 1:40,000
DATE: 18/06/2012



Key for Waiting Restrictions

All areas over which the provision of the orders apply are defined by the shaded areas as shown on the following plans plus a contiguous area not indicated on the plans of verge and/or footway between the carriageway edge and the highway boundary. The plans in this schedule are based upon grid references of the Ordnance Survey National Grid defined by the OSGB 36 triangulation.

Prohibition of waiting

101		check	No waiting at any time	112		dot5	No waiting 8.00am-6.00pm Mon-Fri
103		brick 1	No waiting 7.00am-7.00pm any day	119		tic2	No waiting 2.00pm-3.00pm Mon-Fri

Residents Parking

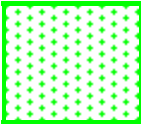
516		usgs721	Residents' and Visitors' permit holders only 9.00am-5.00pm Mon-Fri except bank holidays
-----	--	---------	--

Shared Residents Parking & Free Limited Waiting

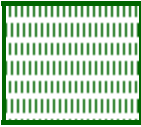
623		pat038	Residents' and Visitors' permit holders and Limited waiting for 2hrs No return within 2hrs for non-permit holders 9.00am-5.00pm Mon-Fri except bank holidays
-----	---	--------	---

Free Limited Waiting

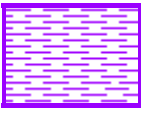
717		shd102	Waiting limited to 1hr No return within 1hr 8.00am-6.00pm Mon-Fri	748		usgs323	Waiting limited to 2hrs No return within 2hrs 9.00am-5.00pm Mon-Fri except bank holidays
-----	---	--------	--	-----	---	---------	---

 Boundary of Controlled Parking Zone

WEST SUSSEX COUNTY COUNCIL
((CRAWLEY BOROUGH) (PARKING PLACES & TRAFFIC REGULATION)
(CONSOLIDATION) ORDER 2010)

(CRAWLEY: STEVENSON WAY AMENDMENT)
ORDER 2012

West Sussex County Council in exercise of their powers under Sections 1 (1) 2 (1) and (2), 4 (2), 45, 46, 49 and 53 and Part IV of Schedule 9 of the Road Traffic Regulation Act 1984 ("the Act") as amended and of all other enabling powers and after consultation with the Chief Officer of Police in accordance with Part III of Schedule 9 to the Act hereby make the following Order:-

1. This Order shall come into operation on the Eighteenth day of June 2012 and may be cited as "West Sussex County Council ((Crawley Borough) (Parking Places & Traffic Regulation) (Consolidation) Order 2010) (Crawley: Stevenson Way Amendment) Order 2012".
2. The "West Sussex County Council (Crawley District) (Parking Places & Traffic Regulation) (Consolidation) Order 2010" is hereby amended by the replacement of the plans specified in the first Schedule to this Order, with the plans specified in the Second Schedule to this Order, attached hereto.
3. The "West Sussex County Council (Crawley District) (Parking Places & Traffic Regulation) (Consolidation) Order 2010" is hereby amended by the insertion of the plan specified in the Third Schedule to this Order, attached hereto.

FIRST SCHEDULE
Plans to be Replaced

TQ2836NEN (Issue Number 1)
TQ2836NES (Issue Number 1)
TQ2836NWS (Issue Number ~~2~~ 2) MM

SECOND SCHEDULE
Replacement Plans

TQ2836NEN (Issue Number 2)
TQ2836NES (Issue Number 2)
TQ2836NWS (Issue Number ~~2~~ 3) MM

THIRD SCHEDULE
Plan to be Inserted

TQ2836SWN (Issue Number 1)

THE Common Seal of THE
WEST SUSSEX COUNTY COUNCIL
was hereto affixed the *FOURTEENTH*

day of *JUNE* 2012



Authorised Signatory
CRE-017-MM

)
)
)
)
)
)
)
)
)
)

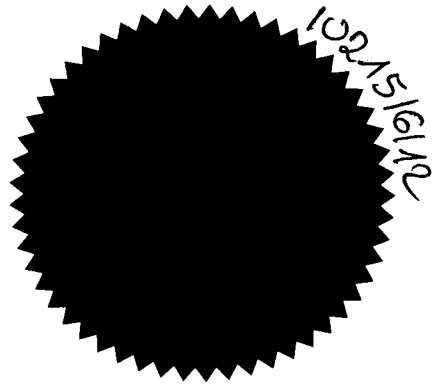

04/08 DELEGATED AUTHORITY

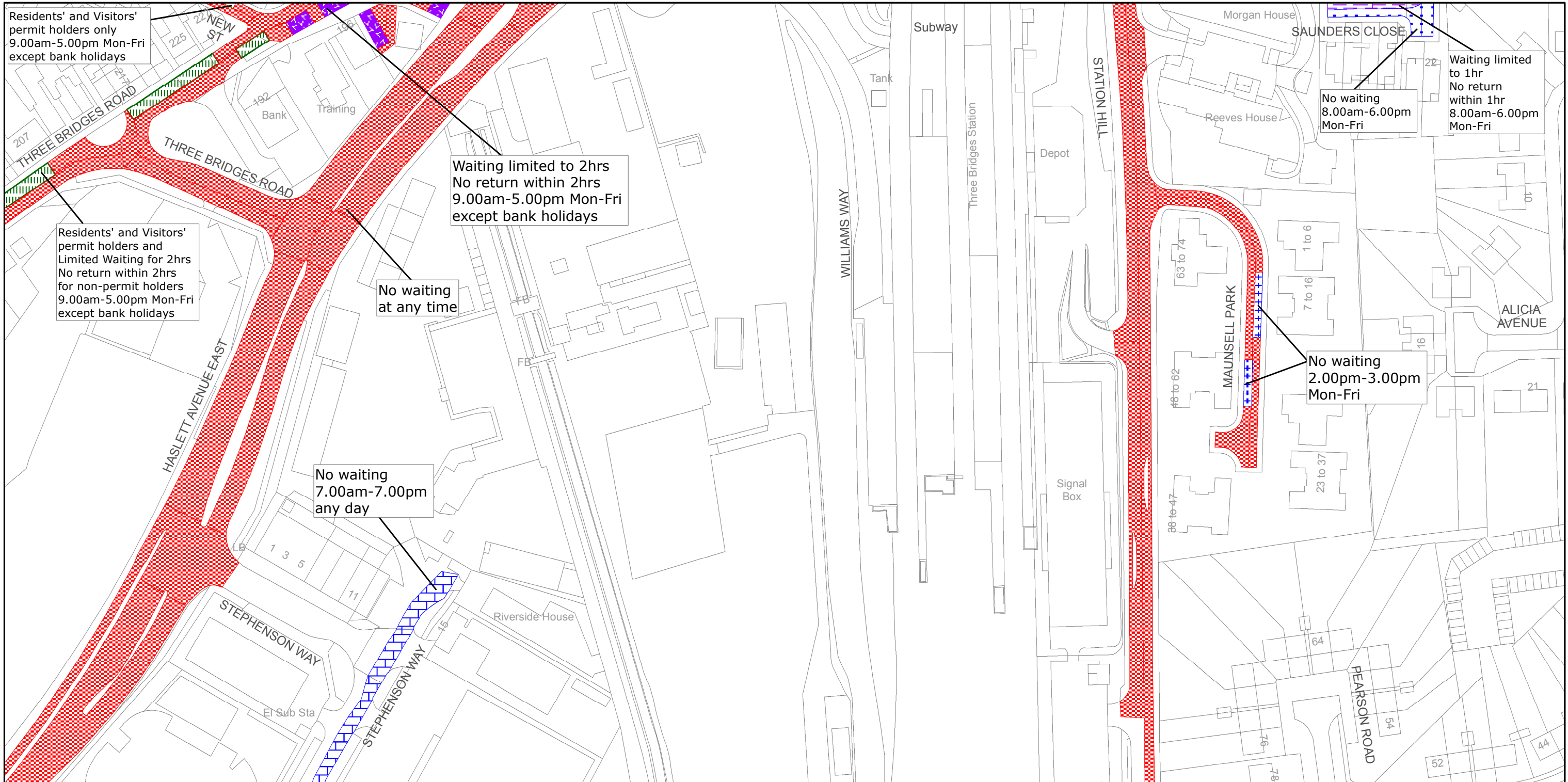

West Sussex County Council
Communities & Infrastructure
The Grange
Tower Street
Chichester
West Sussex
PO19 1RH

CRAWLEY BOROUGH: POUND HILL SOUTH AND WORTH
AND THREE BRIDGES WARDS

WAITING RESTRICTIONS

Reproduced from or based upon 2010 Ordnance Survey mapping with permission of the Controller of HMSO (c) Crown Copyright reserved.
Unauthorised reproduction infringes Crown copyright and may lead to prosecution or civil proceedings West Sussex County Council Licence No. 100023447

TILE REF NO:
TQ2836NEN

SHEET ISSUE NO 2

SHEET ACTIVE FROM - 18/06/2012



SCALE:
1:1250
at A3 size

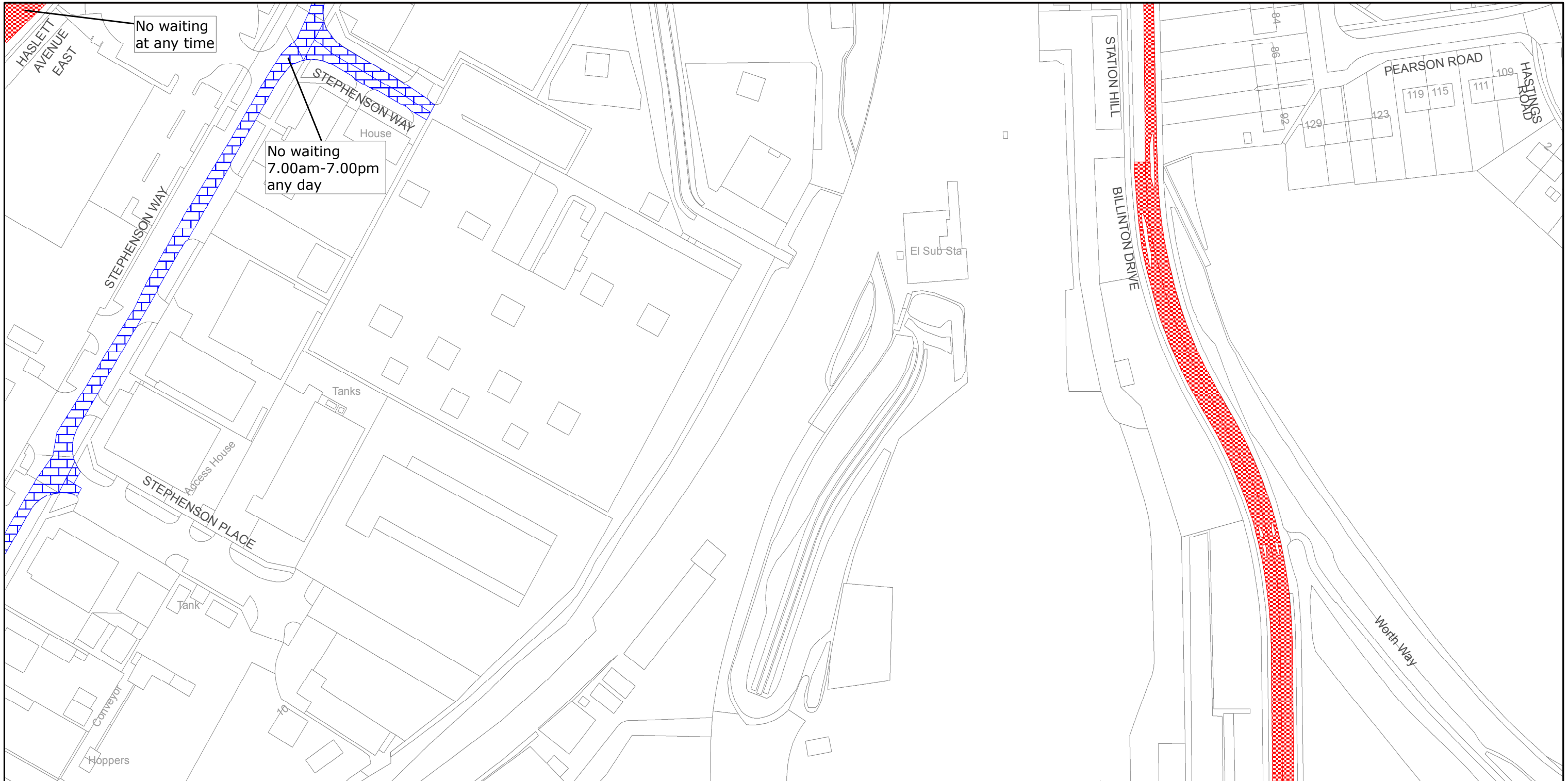

West Sussex County Council
 Communities & Infrastructure
 The Grange
 Tower Street
 Chichester
 West Sussex
 PO19 1RH

CRAWLEY BOROUGH: MAIDENBOWER,
 POUND HILL SOUTH AND WORTH
 AND THREE BRIDGES WARDS

WAITING RESTRICTIONS

Reproduced from or based upon 2010 Ordnance Survey mapping with permission of the Controller of HMSO (c) Crown Copyright reserved.
 Unauthorised reproduction infringes Crown copyright and may lead to prosecution or civil proceedings West Sussex County Council Licence No. 100023447

TILE REF NO:
 TQ2836NES

SHEET ISSUE NO 2

SHEET ACTIVE FROM - 18/06/2012



SCALE:
 1:1250
 at A3 size

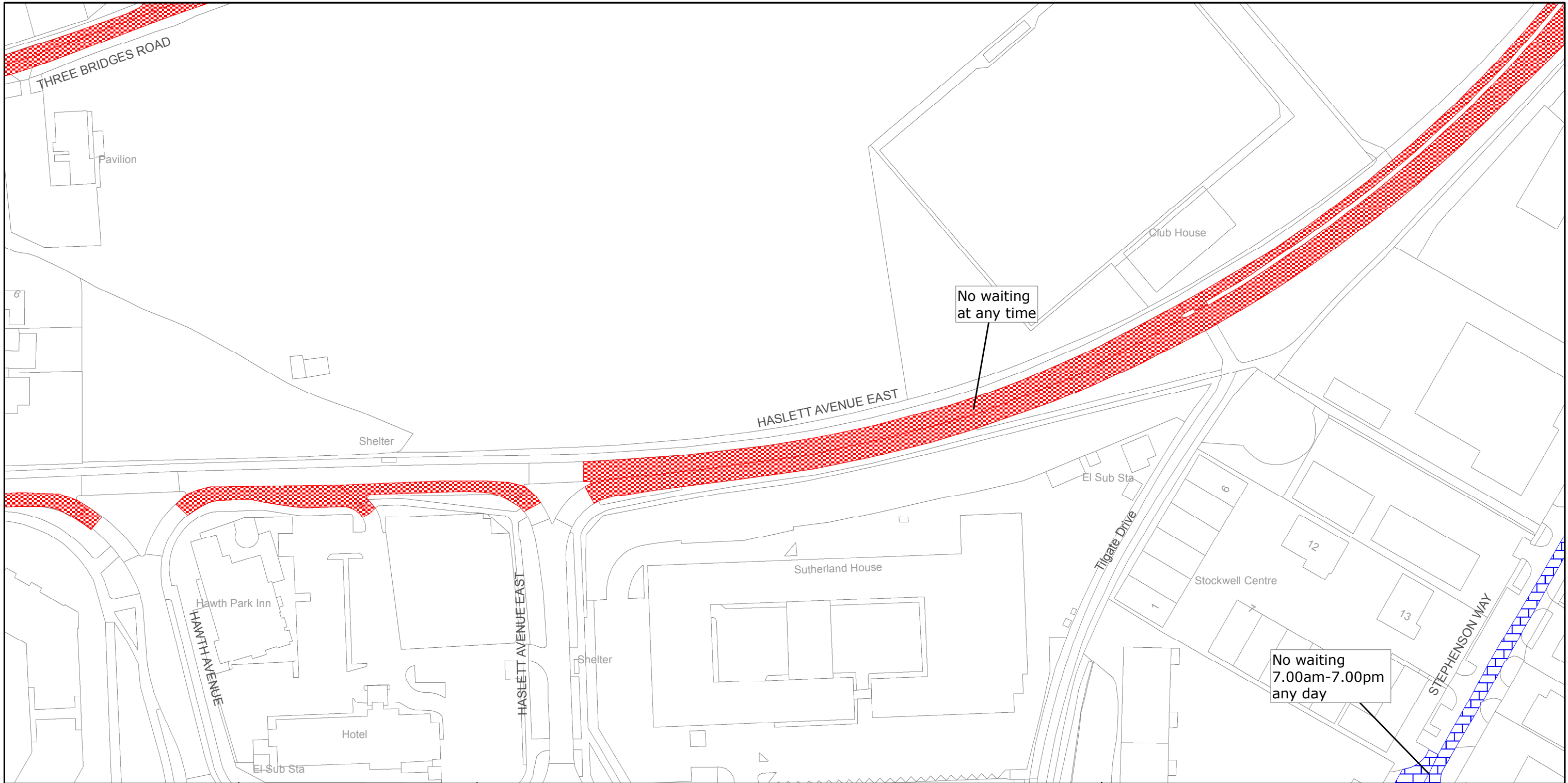

West Sussex County Council
Communities & Infrastructure
The Grange
Tower Street
Chichester
West Sussex
PO19 1RH

CRAWLEY BOROUGH: THREE BRIDGES WARD

WAITING RESTRICTIONS

Reproduced from or based upon 2010 Ordnance Survey mapping with permission of the Controller of HMSO (c) Crown Copyright reserved.
Unauthorised reproduction infringes Crown copyright and may lead to prosecution or civil proceedings West Sussex County Council Licence No. 100023447

TILE REF NO:
TQ2836NWS

SHEET ISSUE NO 3

SHEET ACTIVE FROM - 18/06/2012



SCALE:
1:1250
at A3 size

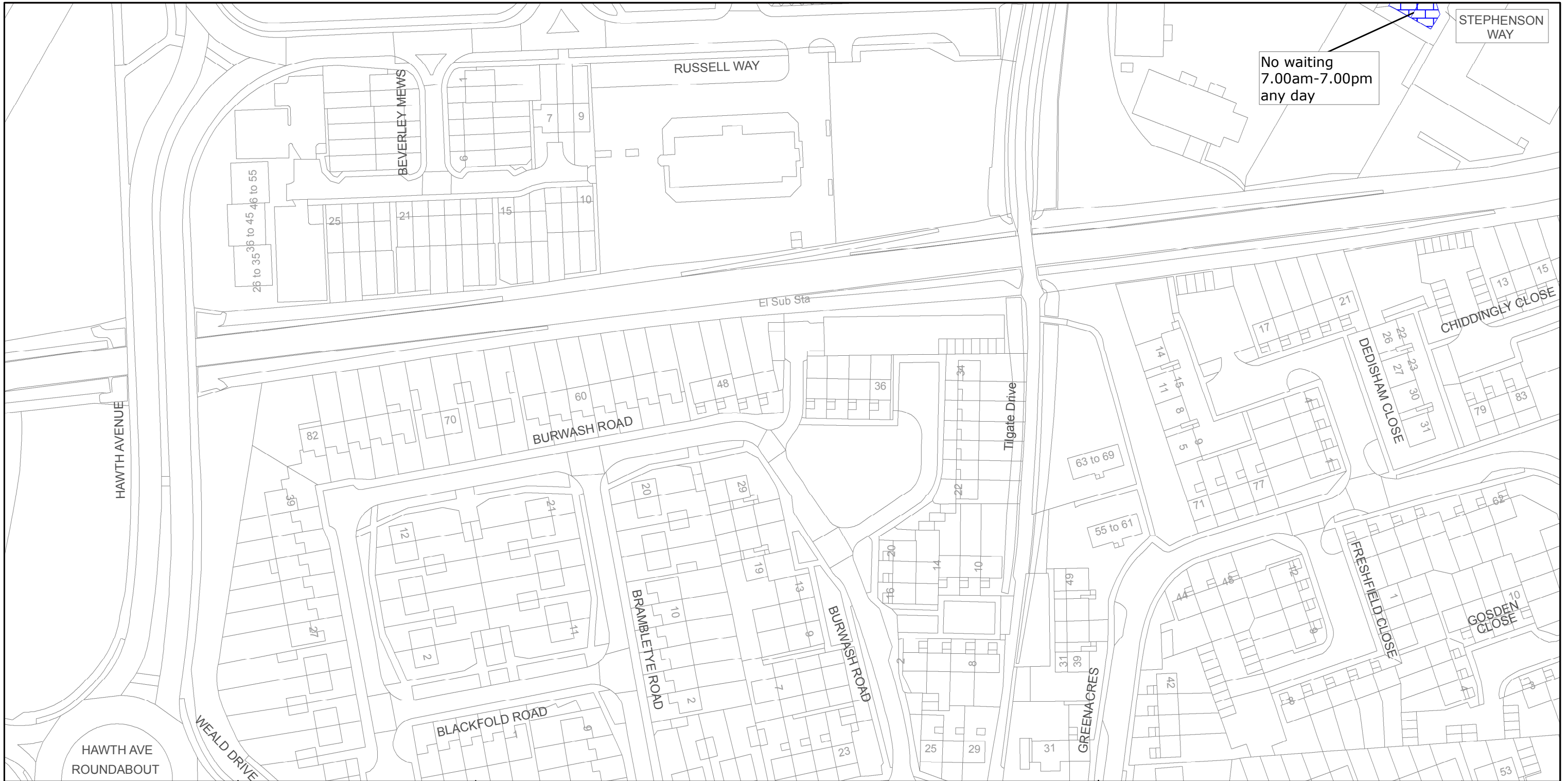

West Sussex County Council
Communities & Infrastructure
The Grange
Tower Street
Chichester
West Sussex
PO19 1RH

CRAWLEY BOROUGH: THREE BRIDGES WARD

WAITING RESTRICTIONS

Reproduced from or based upon 2010 Ordnance Survey mapping with permission of the Controller of HMSO (c) Crown Copyright reserved.
Unauthorised reproduction infringes Crown copyright and may lead to prosecution or civil proceedings West Sussex County Council Licence No. 100023447

TILE REF NO:
TQ2836SWN

SHEET ISSUE NO 1

SHEET ACTIVE FROM - 18/06/2012

N

SCALE:
1:1250
at A3 size